

## Building Information Detailing 2010.3

**Building Information Detailing (BID)** extension works with Revit Architecture, Revit Structure and Revit MEP environment within current project or linked files and provides a set of tools for building model detailing and BIM data analysing.

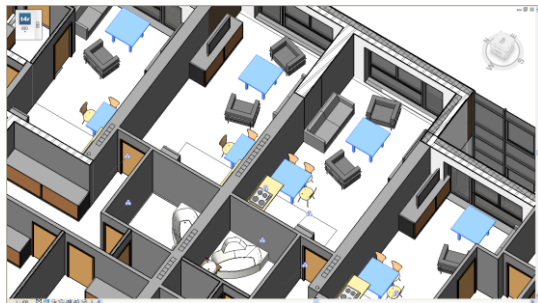

Helps to insert tens of elements (*Structural Elements, Furniture, Lighting Fixtures, Mechanical Equipment, Power Devices etc*) by using built-in (customizable) rules into predefined positions what are logically related with other objects. **New features in v2010.3: more convenient dialog; the element tree is now configurable!** Database of rules can be easy extended by request of users. **New feature in v2010.3: new rules!**



Parameters (type, material and any geometrical data) of hundreds grouped or sorted objects can be easy modified by one click. **New features in v2010.3: works with linked files; more criterions for grouping!**

“Sort Mark” – a new powerful function which allows to number any element in different ways. **New feature in v2010.3!**

Level	Department	RoomName	RoomNumber	Type	Width	Height	Mark
3 Level	A34	Bedroom	336	900 x 2200mm	900	2200	336.A
3 Level	A33	Living Room	337	900 x 2200mm	900	2200	337.A
3 Level	S31	Stairwell	340	1000 x 2100mm	1000	2100	340.A
3 Level	S31	Stairwell	340	1000 x 2100mm	1000	2100	340.C
3 Level	S31	Stairwell	340	1000 x 2100mm	1000	2100	340.D
3 Level	S31	Stairwell	340	1000 x 2100mm	1000	2100	340.B
3 Level	S31	Stairwell	340	1000 x 2100mm	1000	2100	342.A
3 Level	S31	Stairwell	340	1000 x 2100mm	1000	2100	343.A

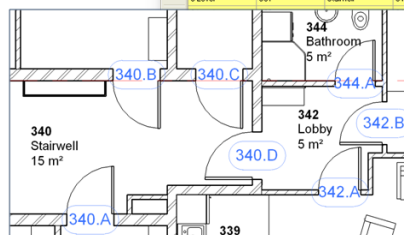

Helps quickly rename/renumber by predefined rules subdivisions of space within a building model like rooms, spaces, zones, areas. **New feature in v2010.3!**

All modifications are going in real time, so the user can easy control this process. **New features in v2010.3: isolates elements in active view; a dynamic section box!**



The “Analyse data” function groups and quantifies objects in different sections of BIM data tree. User can select different grouping opportunities and filter elements for analysis. **New features in v2010.3: works with linked files; more criterions for grouping!**

Calculates areas and room wall finishes and groups all data in different ways. **New feature in v2010.3: more columns with data!**

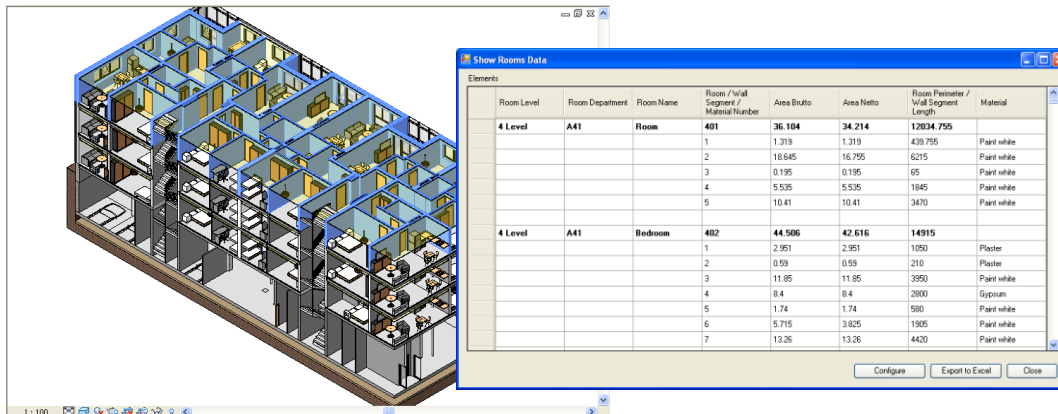

Analysing results can be exported to Excel or built into Revit legends.

Level	Department	Icon 1	Icon 2	Icon 3	Icon 4	Icon 5	Icon 6	Icon 7
1 Level	A11			1		2		3
1 Level	A12	1			2	2		
1 Level	A13			1		1		3
1 Level	A14	1	1		2	1		3
1 Level	A15	1	1		2	1		3
1 Level	A16			1		1		3
1 Level	A17	1			2	1		3
1 Level	A18			1		1		3

Any model elements can be selected using different built-in rules. **New feature in v.2010.3: more criterions in configuration!**



There are possible other forms to show and put on paper analysing results. Connections with different systems (ERP, Cost estimating solutions and etc) are available by request of users.

**BID** supports metric and imperial unit systems.  
Language: English.

More information: [www.tools4revit.com](http://www.tools4revit.com)