



# Insert/Update Hip/Valley Rafter Rafter+FF

How to use Hip and Valley Rafter command step by step



# Before Proceeding

- Please read the topic *“How to frame correctly layers of the wood roof”* carefully.

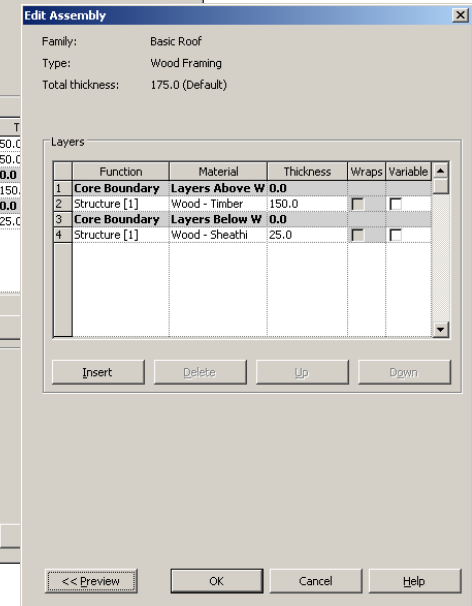
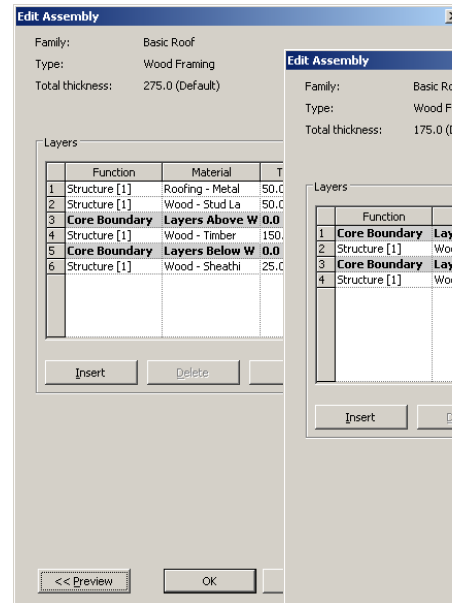
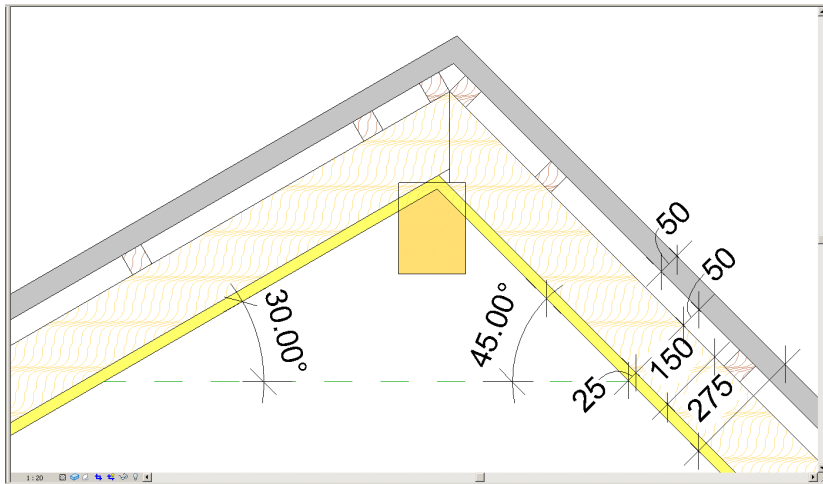
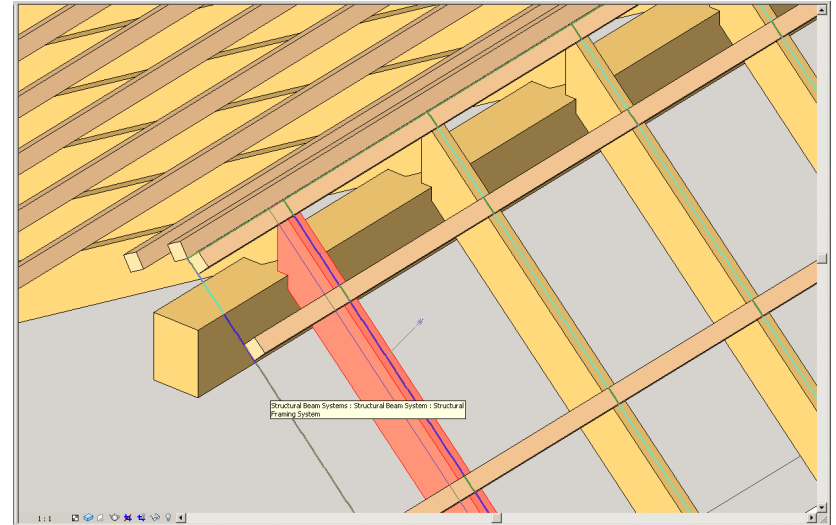



# Configure Hip/Valley Rafter

- Now you can choose *End cut type* of a rafter.
- Provide dimensions of the rafter cross section: *width - b* and *height (depth) – h (d)*.
- Enter the *End cut height* dimension **h1** if required.
- Click *OK* to create Hip Rafter.

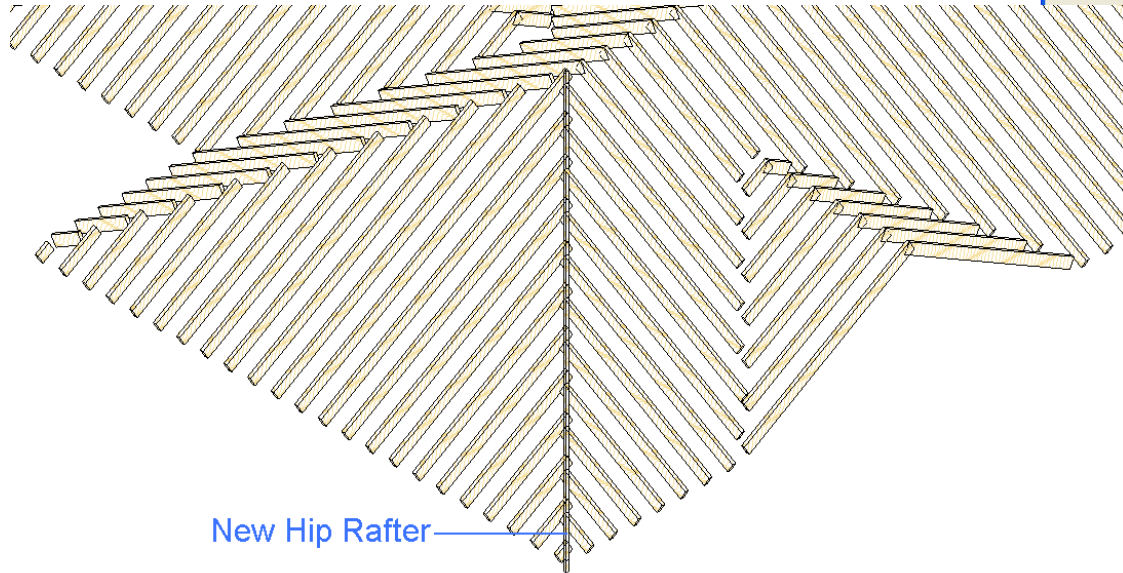
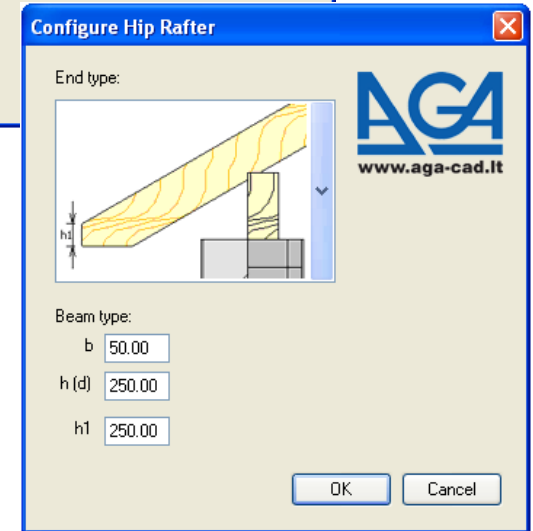

New Hip Rafter

# Update Existing Hip/Valley Rafter

- Select the hip/valley rafter or multiple hip/valley rafters you want to update.
- Select the function *Insert/Update hip/valley rafter* from the menu.
- Make your changes for *End cut type* of the rafter or *Cross section dimensions* and click *OK*.

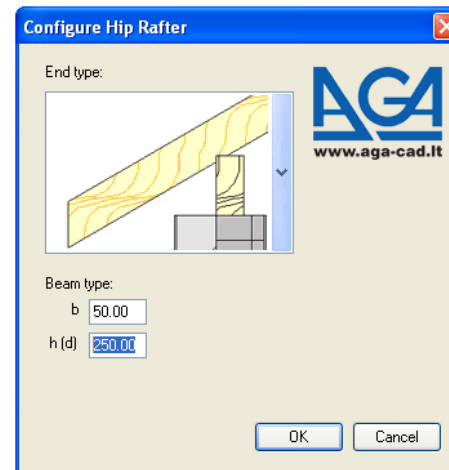
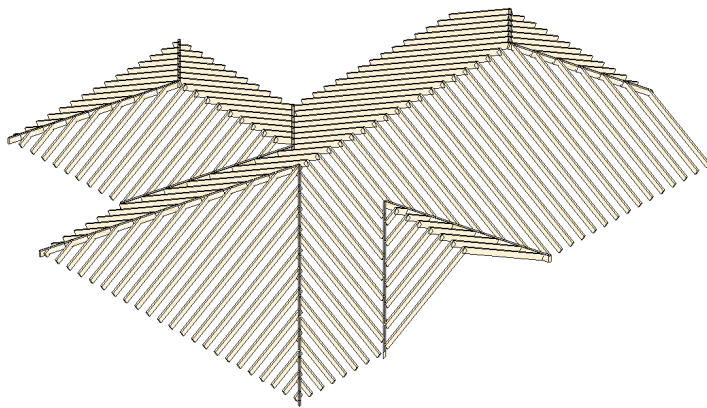
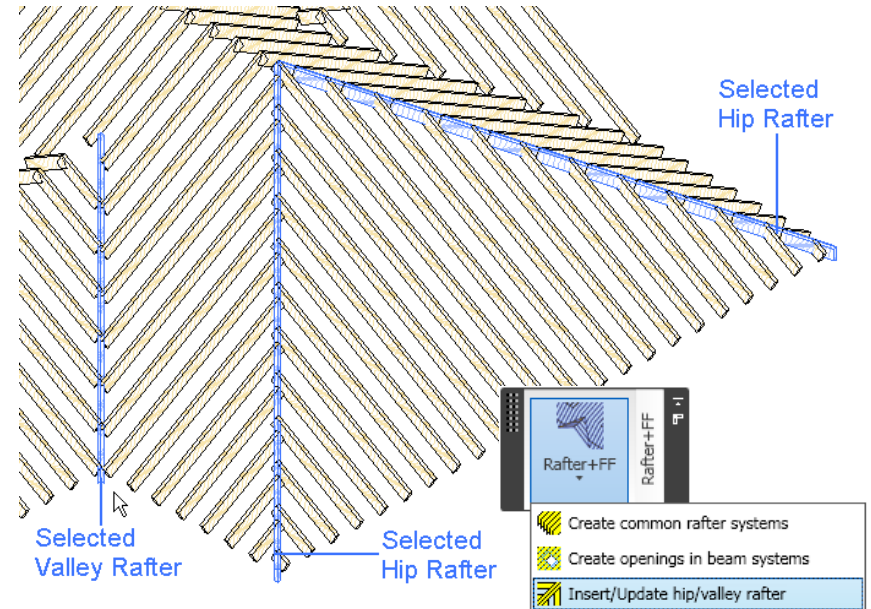

# Increase your productivity !



AGA CAD Ltd.  
Zalgirio 112A, LT-09300 Vilnius,  
Lithuania  
Tel. +370 5 2398111  
Fax +370 5 2398113  
Email [info@aga-cad.lt](mailto:info@aga-cad.lt)  
[info@tools4revit.com](mailto:info@tools4revit.com)  
[www.tools4revit.com](http://www.tools4revit.com)